



INSTALLATION INSTRUCTIONS

ProMaster® Ignition Coil PN 29440

Parts Included:

1 - Ignition Coil	2 - Ring Terminals
1 - Ignition Coil Bracket	3 - Screws, #10 x 3/4"
1 - Screw, #10 x 1"	
1 - Coil Wire Boot	
1 - Coil Wire Terminal	

GENERAL INFORMATION

Check the ignition coil application to be sure it is being used in the proper application for optimum performance.

Spark Plug Wires and Coil Wire

To prevent false triggering and possibility of premature ignition failures, use suppression type spark plug wire.

Spark Plug Gaps

For street applications, use your engine manufacturer's specifications. For racing applications, start with your engine manufacturer's specifications, then experiment with and closely monitor various gaps to achieve maximum performance.

MOUNTING PROCEDURE

Ignition coils should be mounted on a flat surface as close as possible to the distributor and away from extreme heat from engine components. DO NOT mount ignition coils to the engine.

- Step 1:** PROMASTER® Ignition Coils may be mounted at any angle. Find a suitable flat surface to mount the ignition coil.
- Step 2:** Center punch the mounting pattern using the ignition coil bracket as a template to mark locations for drilling holes. Drill holes using a 9/64" drill bit.
- Step 3:** Mount the ignition coil bracket using three #10 x 3/4" screws.
- Step 4:** Slide the ignition coil into the ignition coil bracket. Mount the ignition coil in the ignition coil bracket with the #10 x 1" screw.

COIL WIRE INSTALLATION

- Step 1:** Strip 5/8" of insulation from the coil wire. Fold the core over the outside of the coil wire.
- Step 2:** Put the coil wire terminal on the end of the coil wire and crimp the connection.
- Step 3:** Slide the coil wire into the coil wire boot. Install the coil wire on the high voltage terminal. See Figure 1.

WIRING PROCEDURE

See pages 2 and 3 for wiring diagrams and information.

NOTE: If you are using an aftermarket ignition control, such as a Mallory HYFIRE® Ignition Control or similar, follow the wiring instructions included with your ignition control box.

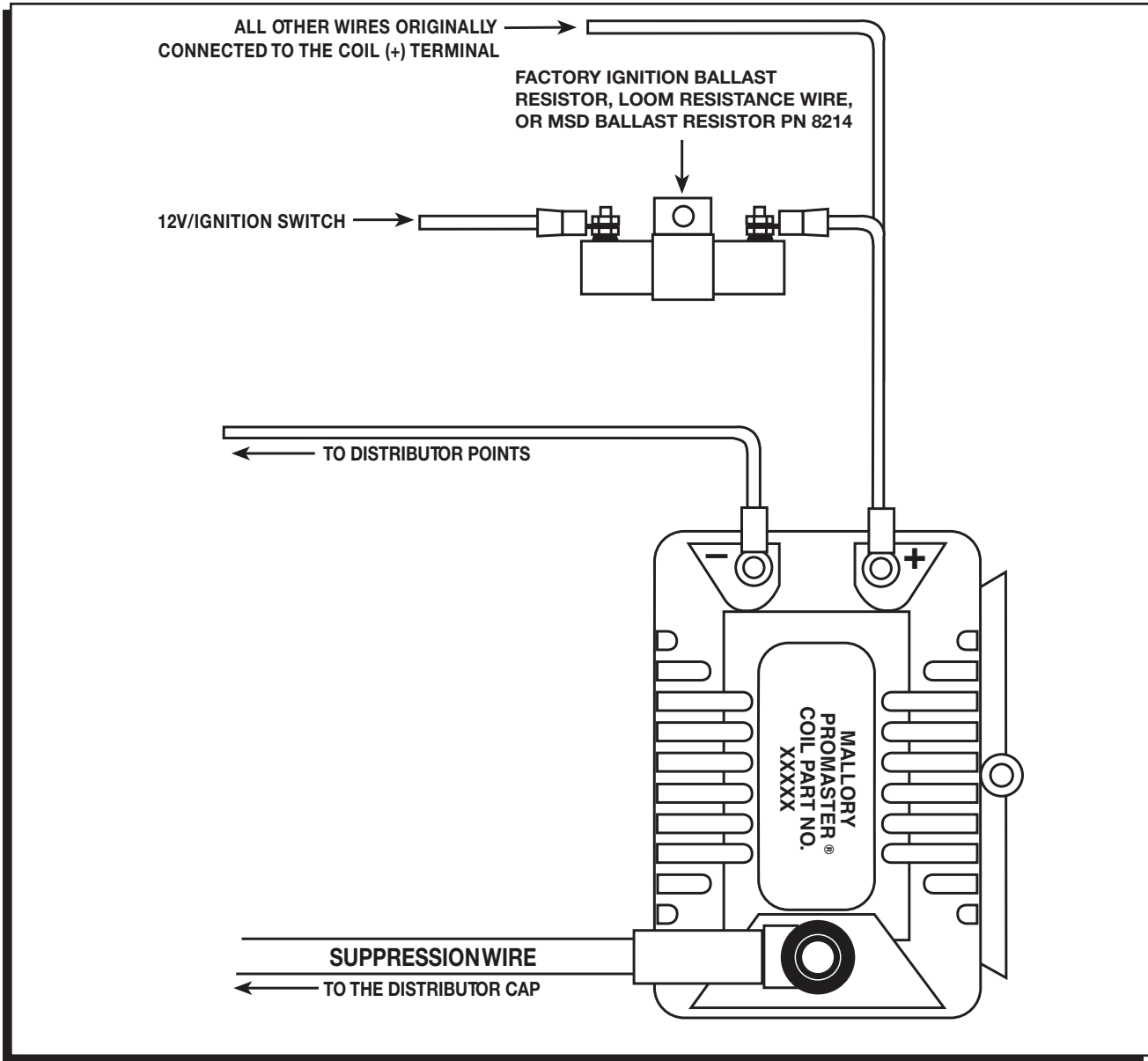

Figure 1 Breaker Point Ignition - Single or Dual Points

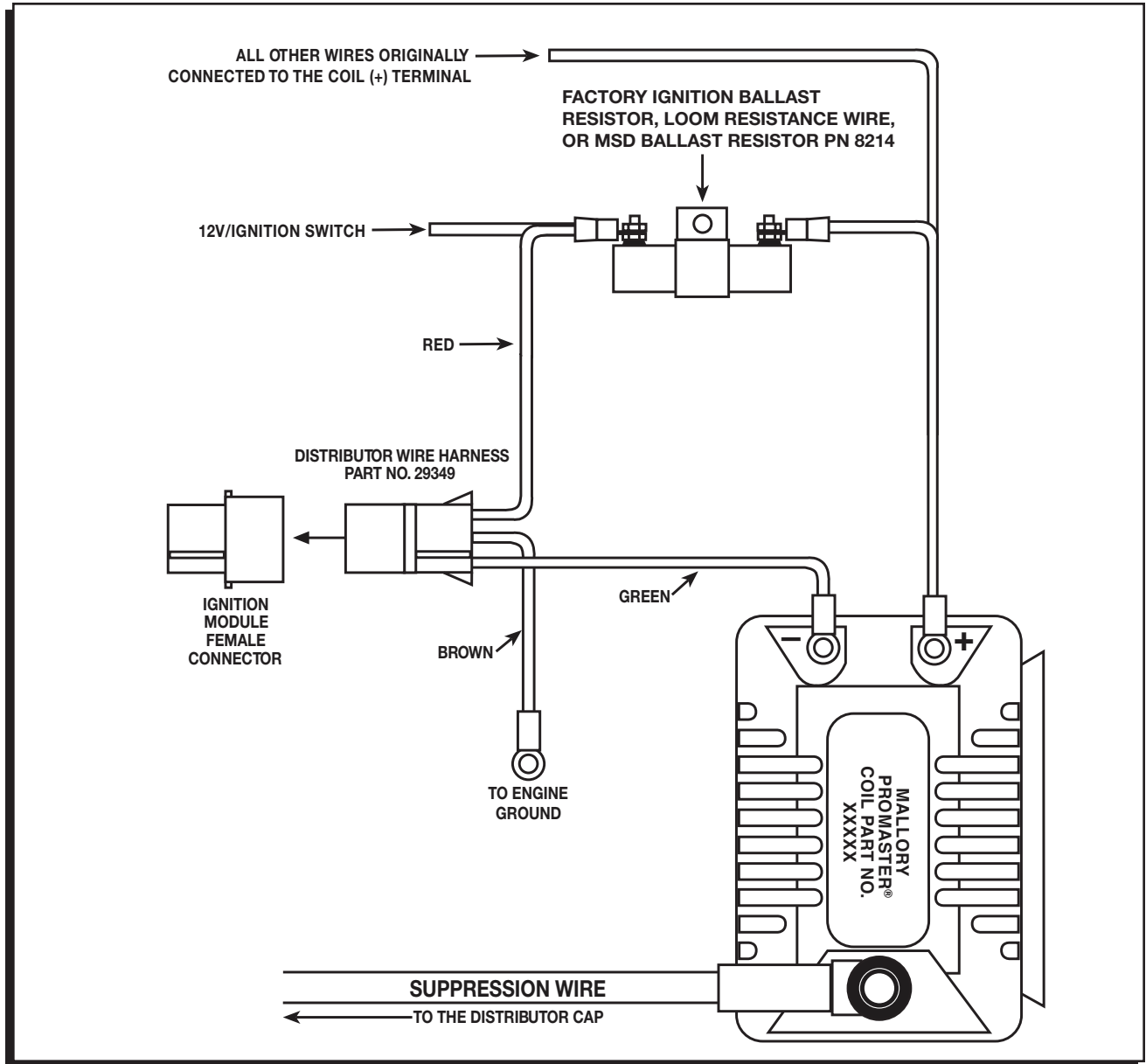

Figure 2 Mallory Electronic Ignition - Unilite® Electronic Ignition, Magnetic Breakerless Ignition, Electronic Advance Ignition

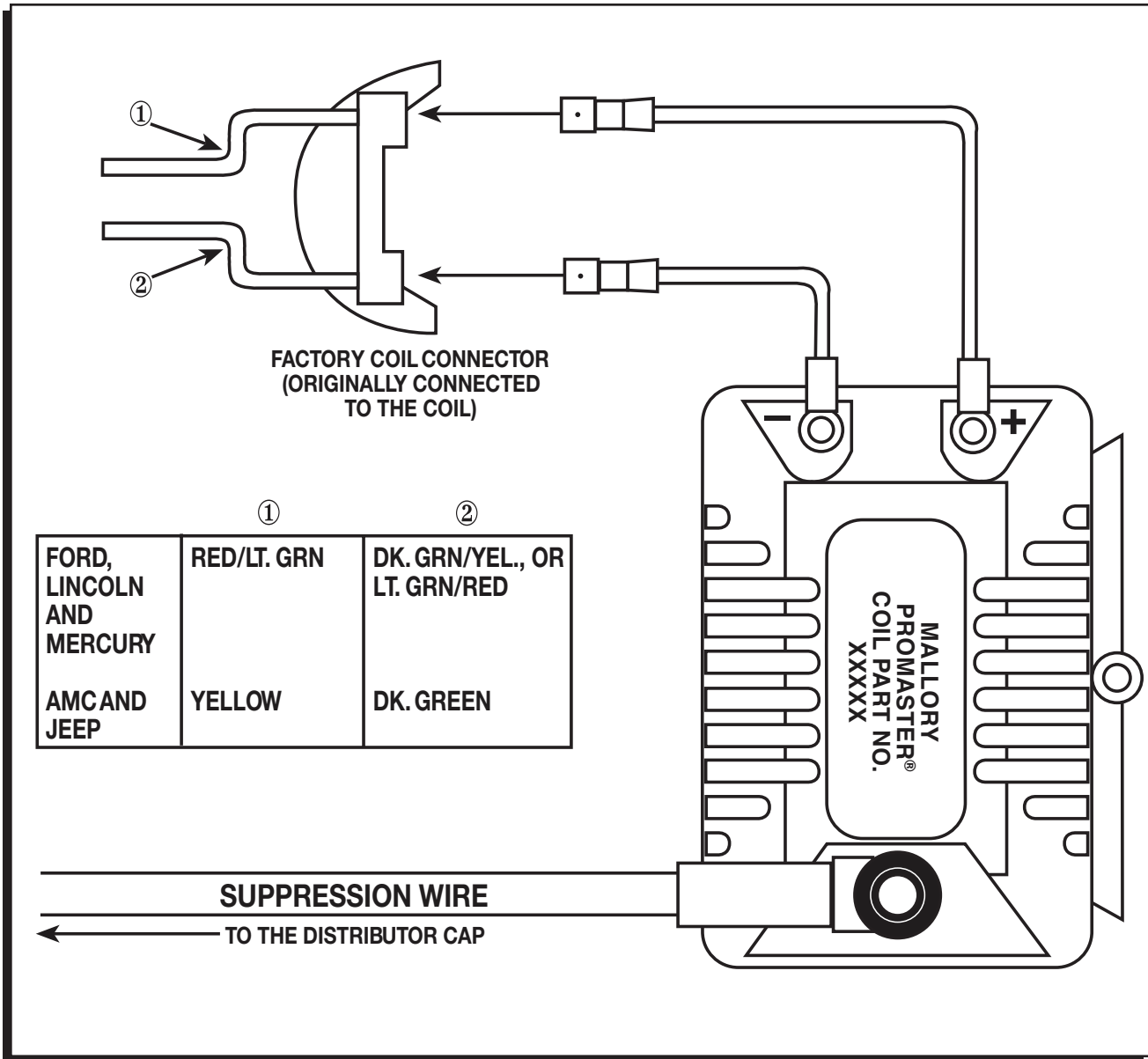

Figure 3 Motorcraft/Duraspark Ignition - Ford, Lincoln, Mercury, AMC and Jeep

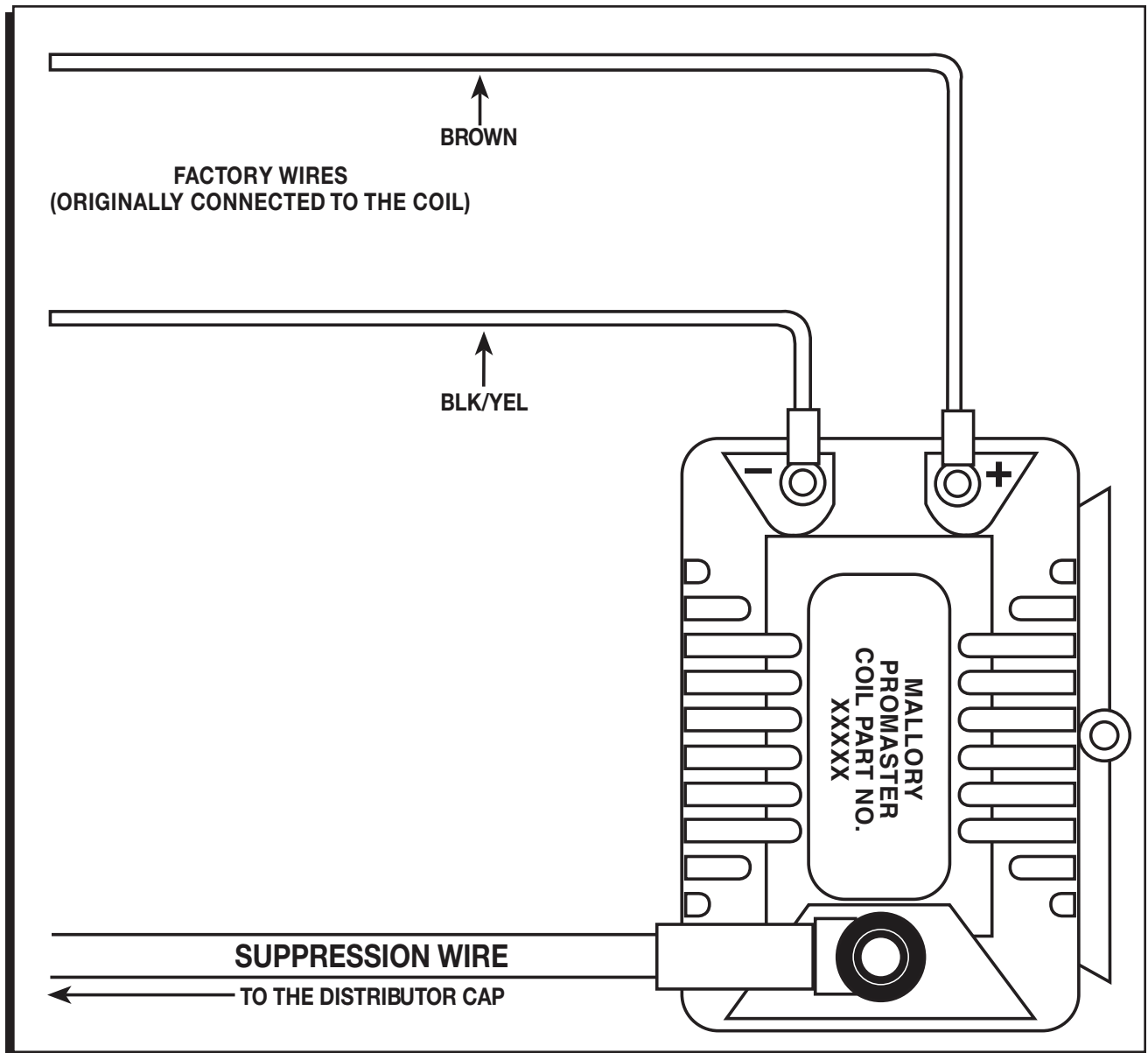

Figure 4 Chrysler Electronic Ignition

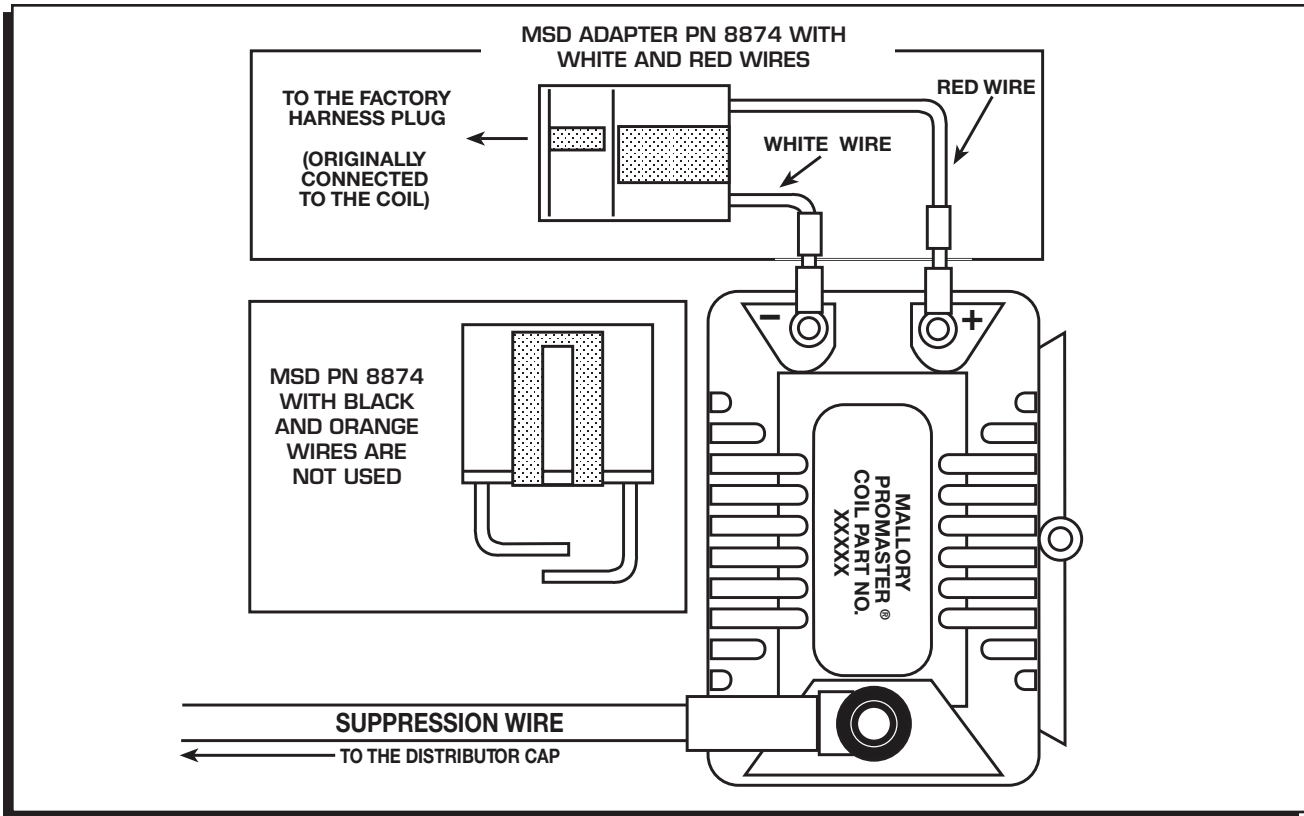

Figure 5 Ford TFI Systems - Use Mallory Adapter PN 29062 to Interchange a Promaster® Coil without cutting wires.



INSTALLATION INSTRUCTIONS

TECH NOTES

Service

In case of malfunction, this MSD component will be repaired free of charge according to the terms of the warranty. When returning MSD components for warranty service, **Proof of Purchase** must be supplied for verification. After the warranty period has expired, repair service is based on a minimum and maximum fee.

All returns must have a Return Material Authorization (RMA) number issued to them before being returned. To obtain an RMA number please contact MSD Customer Service at 1 (888) MSD-7859 or visit our website at www.msdpower.com/rma to automatically obtain a number and shipping information.

When returning the unit for repair, leave all wires at the length in which you have them installed. Be sure to include a detailed account of any problems experienced, and what components and accessories are installed on the vehicle. The repaired unit will be returned as soon as possible using Ground shipping methods (ground shipping is covered by warranty). For more information, call MSD at (915) 855-7123. MSD technicians are available from 7:00 a.m. to 5:00 p.m. Monday - Friday (mountain time).

Limited Warranty

MSD warrants this product to be free from defects in material and workmanship under its intended normal use*, when properly installed and purchased from an authorized MSD dealer, for a period of one year from the date of the original purchase. This warranty is void for any products purchased through auction websites. If found to be defective as mentioned above, it will be repaired or replaced at the option of MSD. Any item that is covered under this warranty will be returned free of charge using Ground shipping methods.

This shall constitute the sole remedy of the purchaser and the sole liability of MSD. To the extent permitted by law, the foregoing is exclusive and in lieu of all other warranties or representation whether expressed or implied, including any implied warranty of merchantability or fitness. In no event shall MSD or its suppliers be liable for special or consequential damages.

*Intended normal use means that this item is being used as was originally intended and for the original application as sold by MSD. Any modifications to this item or if it is used on an application other than what MSD markets the product, the warranty will be void. It is the sole responsibility of the customer to determine that this item will work for the application they are intending. MSD will accept no liability for custom applications.