



# MasterShift

## Installation Instructions

U.S. Patent No. RE 25,561 & 3,052,135

**ATTENTION**

Due to variations in auto manufacturing tolerances, the transmission rods supplied with this kit may require slight bending to clear obstructions, etc.

Protect the threads while bending.

**BEND RODS COLD! - DO NOT APPLY HEAT!**

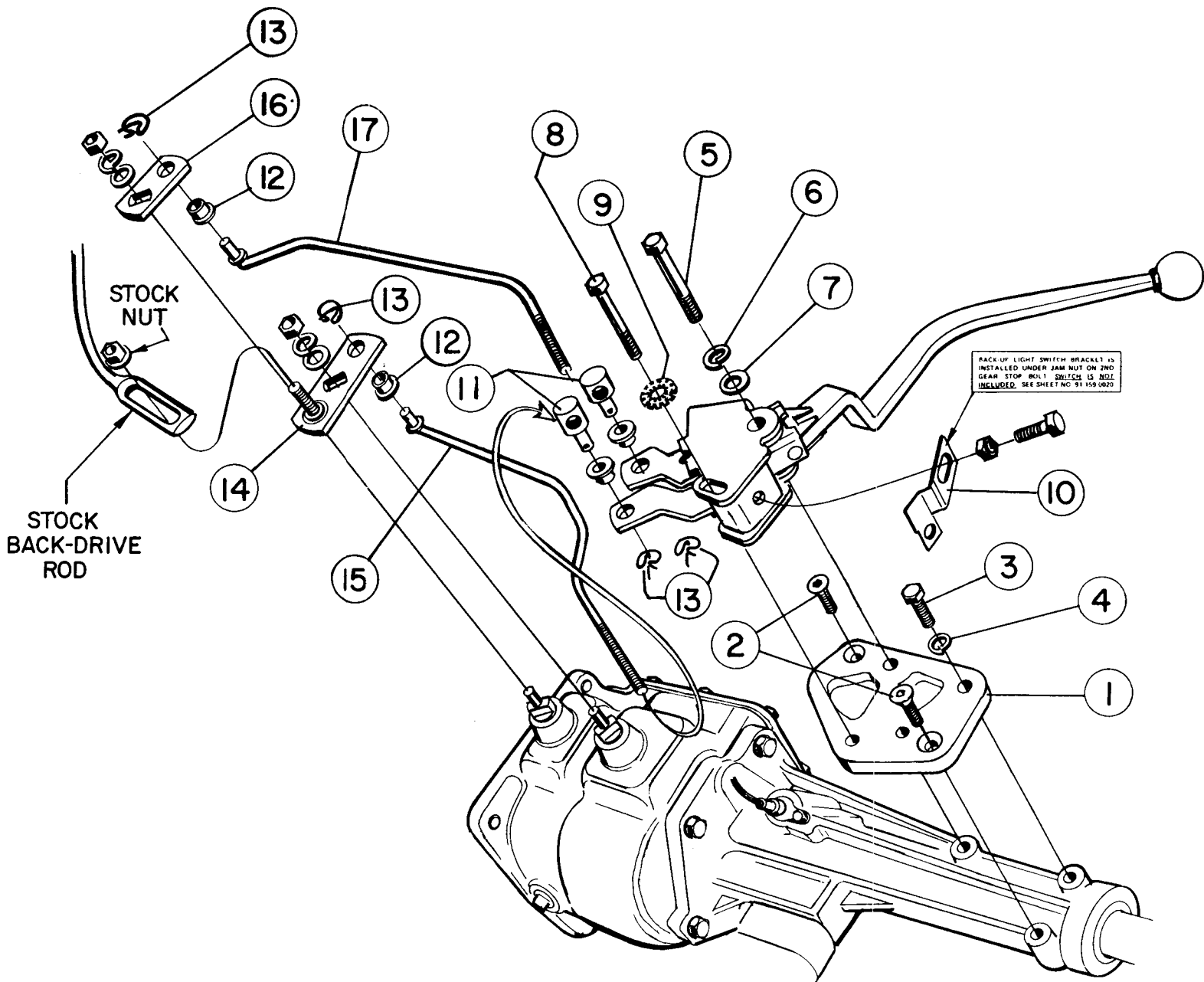

### CONTENTS OF KIT

- |     |   |                  |
|-----|---|------------------|
| 1.  | MOUNTING PLATE                          | Pt. 195 3176     |
| 2.  | 5/16 - 18 x 1 FLAT HEAD SOCKET SCREW    | (2)              |
| 3.  | 5/16 - 18 x 1 HEX HEAD CAP SCREW        |                  |
| 4.  | 5/16" SPLIT LOCKWASHER                  |                  |
| 5.  | 7/16 - 14 x 2 3/4 HEX HEAD CAP SCREW    |                  |
| 6.  | 7/16" SPLIT LOCKWASHER                  |                  |
| 7.  | 7/16" FLATWASHER                        |                  |
| 8.  | 3/8 - 16 x 2 3/4 HEX HEAD CAP SCREW     |                  |
| 9.  | 3/8" INTERNAL/EXTERNAL TOOTH LOCKWASHER |                  |
| 10. | BACK-UP LIGHT SWITCH BRACKET            | Pt. 117 0006     |
| 11. | ROD ADJUSTING BUTTON                    | Pt. 119 3783 (2) |
| 12. | NYLON BUSHING                           | Pt. 118 1681 (4) |
| 13. | SPRING CLIP                             | Pt. 97000015 (4) |
| 14. | ARM 1st/REV.                            | Pt. 105 7645     |
| 15. | ROD 1st/REV.                            | Pt. 213 2758     |
| 16. | ARM 2nd/3rd                             | Pt. 105 1779     |
| 17. | ROD 2nd/3rd                             | Pt. 213 3172     |

BAGGED HARDWARE Pt. 154 0024

# 367 7640